

Maps reproduced with permission of The Director of Lands. (C) Hong Kong Government.

FILENAME: G:\env\project\23573\drawings\3rd EIA\18\Figure\Figure9-1.dgn

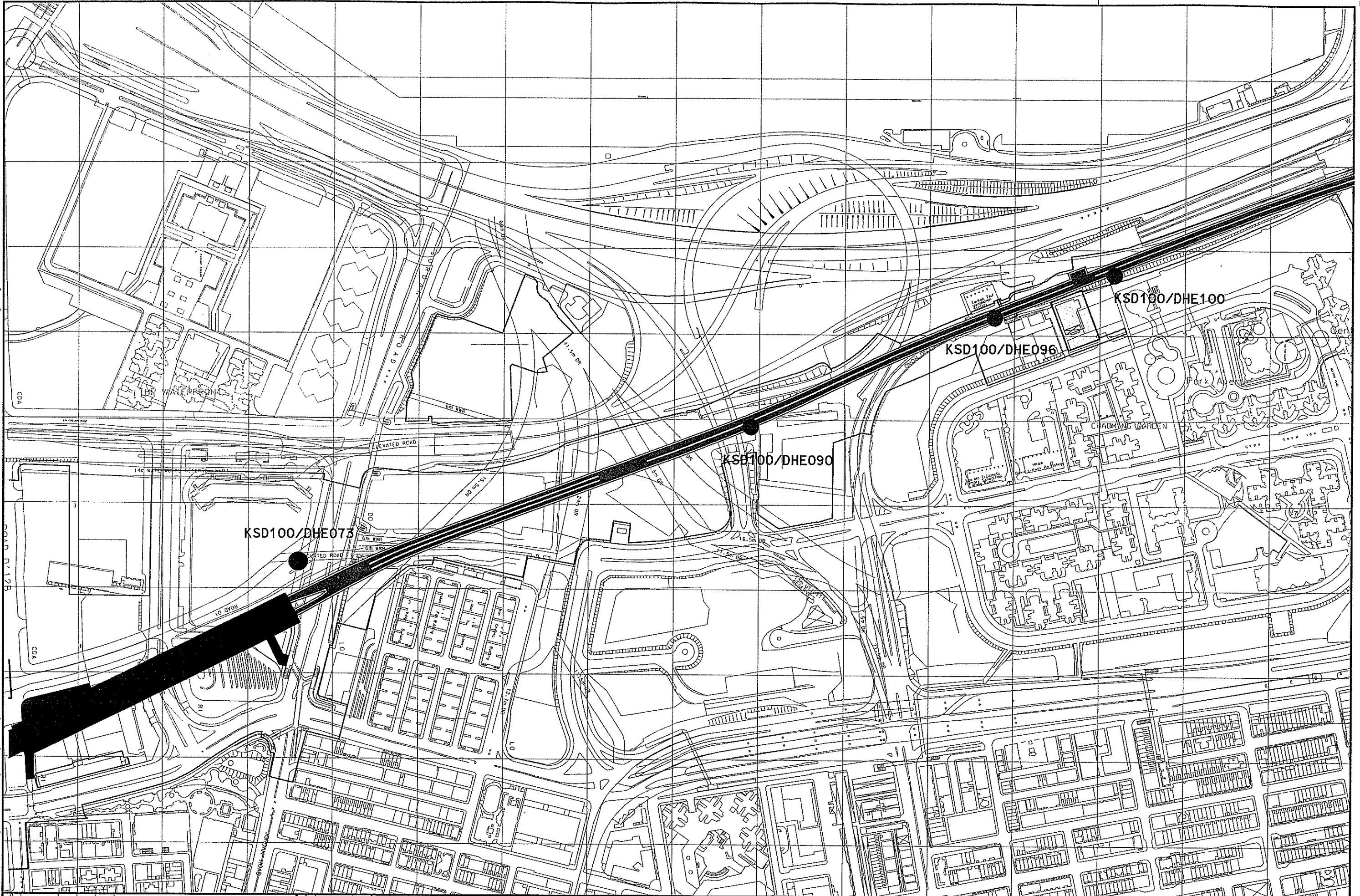

REV	DATE	BY	SUB	APP	DESCRIPTION
△	DEC2003	SW	FC	ST	EIA REPORT
△	NOV2003	SW	FC	ST	EIA REPORT
△	JUNE2003	SW	FC	ST	EIA REPORT
△	7MAR2003	SW	FC	ST	EIA REPORT (2ND DRAFT)
△	11OCT2002	SW	FC	ST	EIA REPORT (1ST DRAFT)

DESIGNED BY	SW
DRAWN BY	JF
CHECKED BY	FC
IN CHARGE	ST
DATE	5 DEC 2003



New Railway Projects
新鐵路策劃

Ove Arup & Partners Hong Kong Limited **ARUP**

KOWLOON SOUTHERN LINK KSL GSA-5100
EIA & ASSOCIATED SERVICES
LOCATIONS OF EXCAVATED MARINE DEPOSITS TESTED FOR BIOLOGICAL SCREENING

CADD FILENAME	CADD DATE
SCALE	5 DEC 2003
DRAWING NUMBER	1:4000 @ A3
FIGURE 9-1	
SHEET NO	STAGE CODE REV
	P E



Maps reproduced with permission of The Director of Lands, (C) Hong Kong Government.

FILENAME: G:\env\project\23573\drawings\3rd EIA-V8\Figure\Figure9-2a.dgn

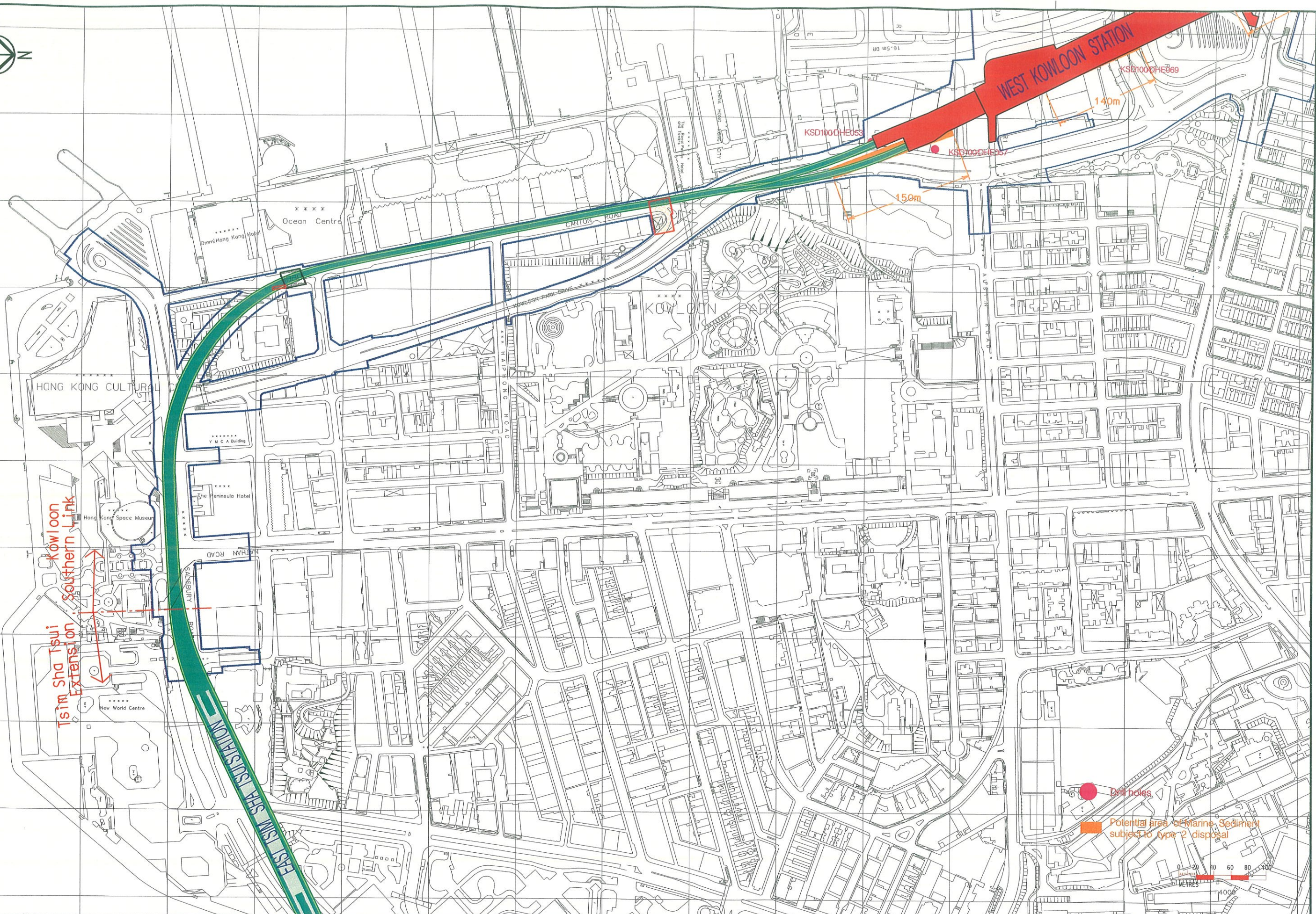

REV	DATE	BY	SUB	APP	DESCRIPTION
△	DEC2003	SW	FC	ST	EIA REPORT
△	NOV2003	SW	FC	ST	EIA REPORT
△	30MAY2003	SW	FC	ST	EIA REPORT
△	7MAR2003	SW	FC	ST	EIA REPORT (2ND DRAFT)
△	11OCT2002	SW	FC	ST	EIA REPORT (1ST DRAFT)

DESIGNED BY SW
 DRAWN BY RL
 CHECKED BY FC
 IN CHARGE ST
 DATE 5 DEC 2003



New Railway Projects
新鐵路策劃

奧雅納工程顧問
 Ove Arup & Partners Hong Kong Limited



KOWLOON SOUTHERN LINK KSL GSA-5100
EIA & ASSOCIATED SERVICES

AREAS OF MARINE SEDIMENT
SUBJECT TO TYPE II DISPOSAL

CADD FILENAME	CADD DATE
SCALE	1 : 4000 @ A3
DRAWING NUMBER	FIGURE 9-2-1
SHEET NO	STAGE CODE REV
1 OF 3	P E